

**13 ROLLING GATE**  
Scale: 1/2" = 1'-0"

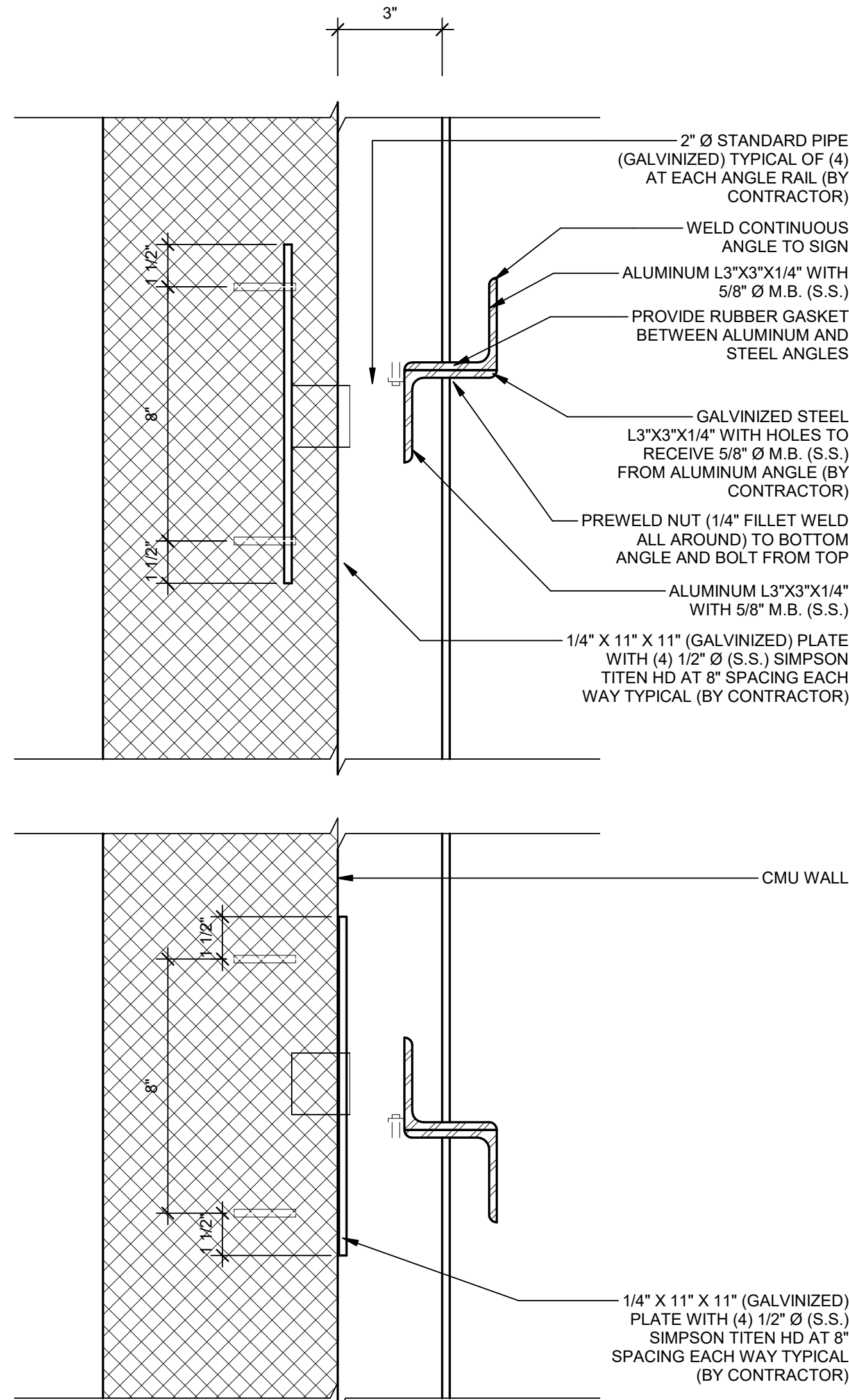

**1 LOGO SIGNAGE ATTACHMENT AT CMU WALL**  
Scale: 3" = 1'-0"

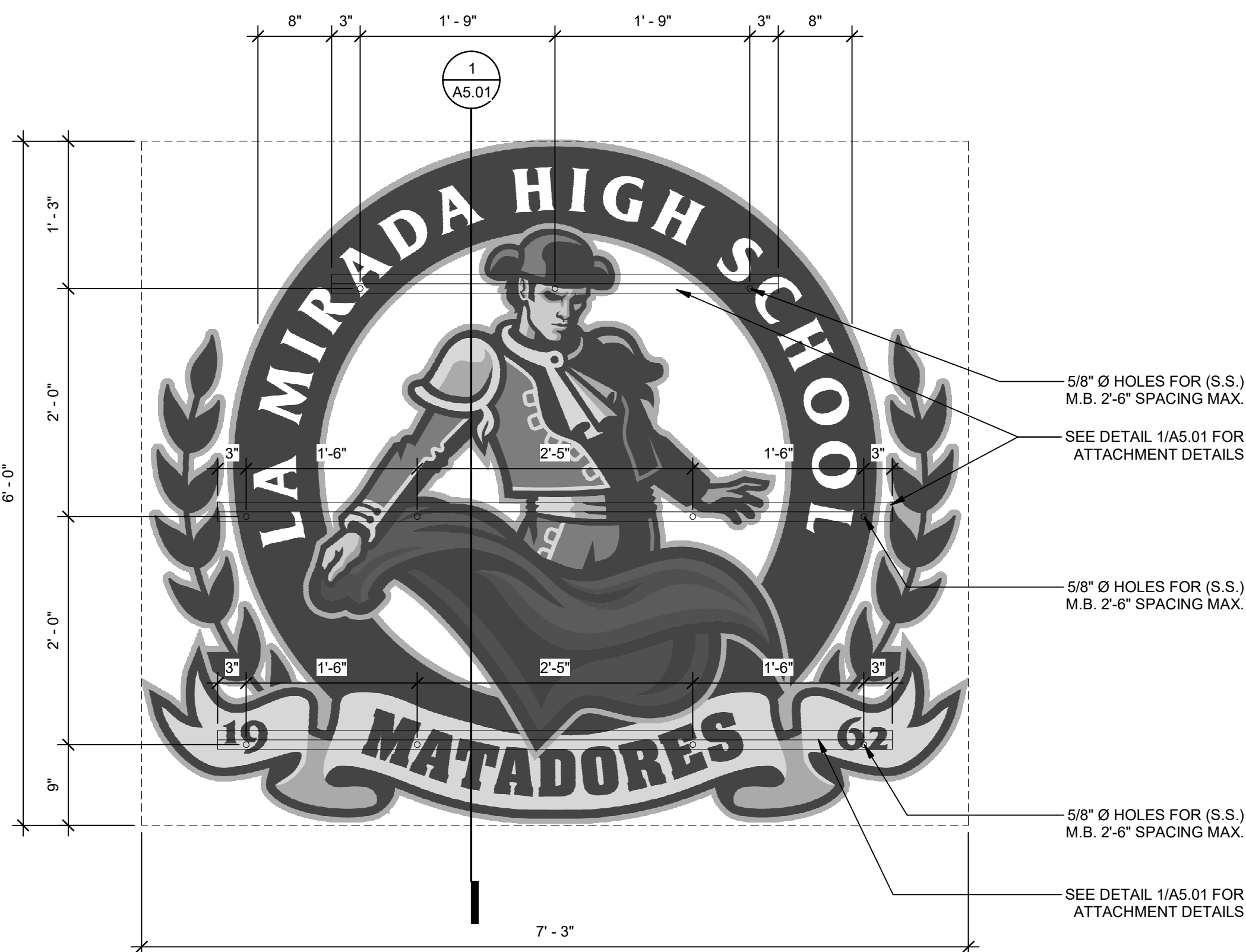

**2 BUILDING V LOGO SIGNAGE ELEVATION**  
Scale: 1" = 1'-0"

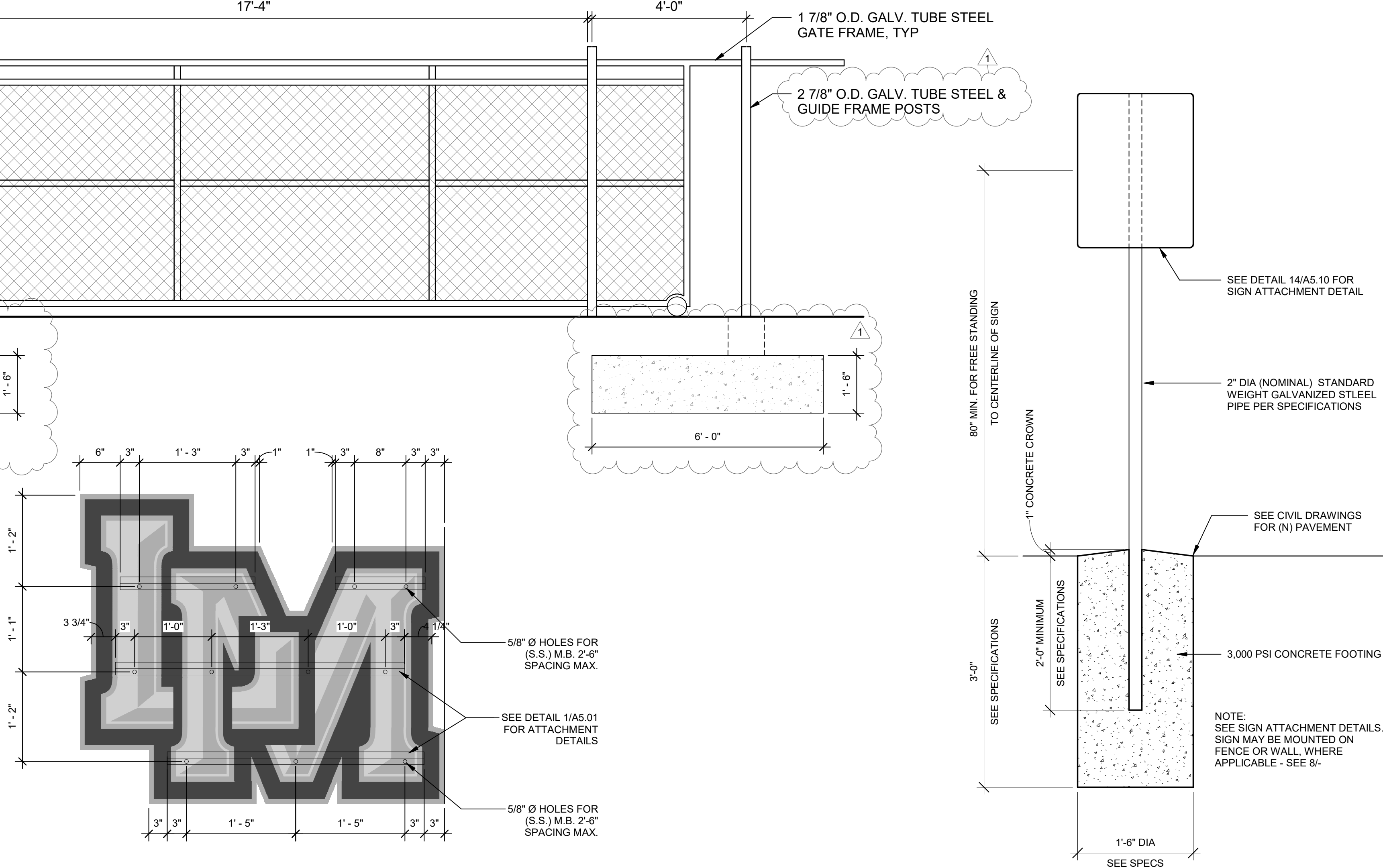

**12 TICKET BOOTH LOGO SIGNAGE ELEVATION**  
Scale: 1" = 1'-0"

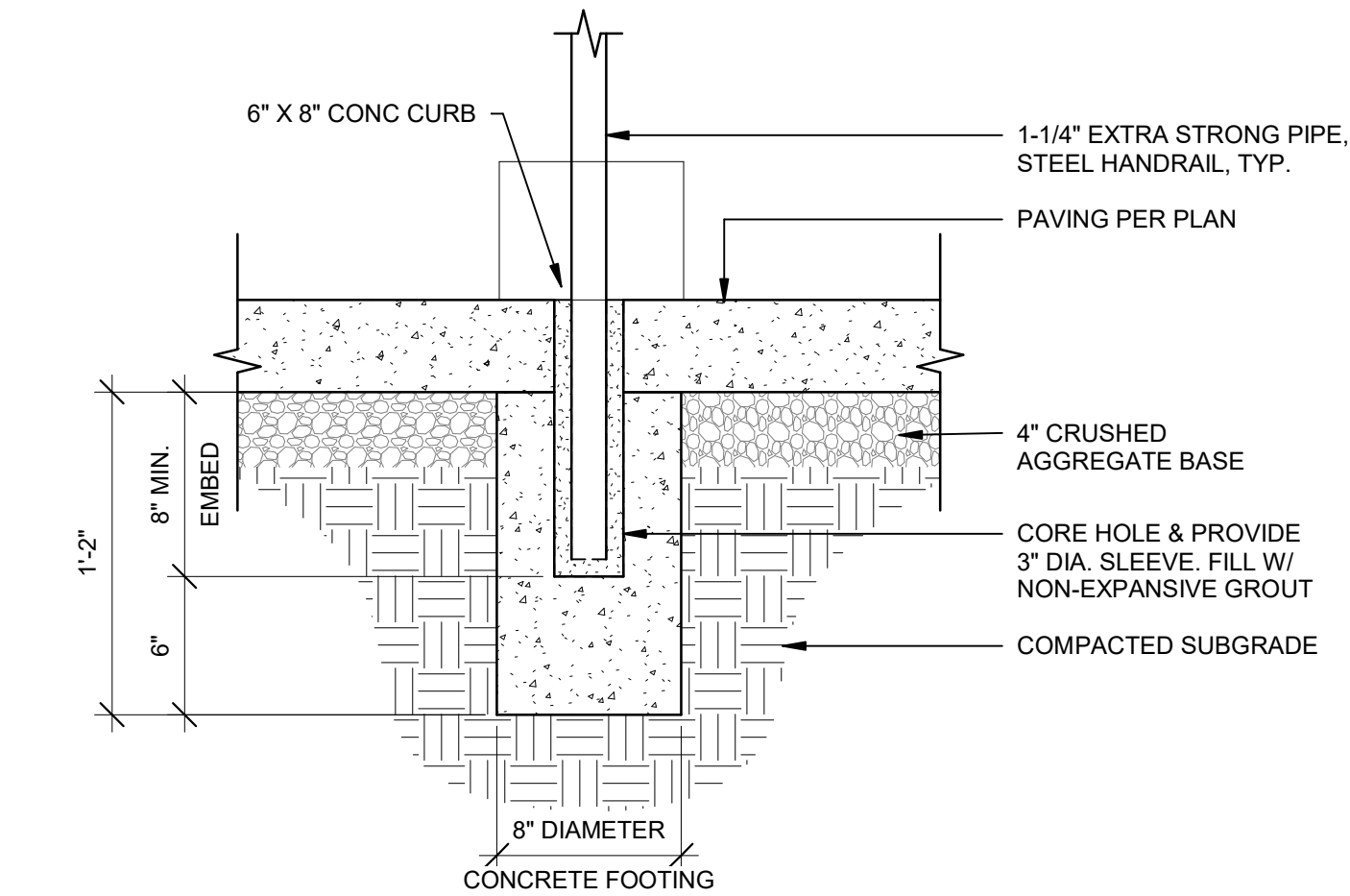

**11 RAILING EMBEDMENT, TYP.**  
Scale: 1 1/2" = 1'-0"

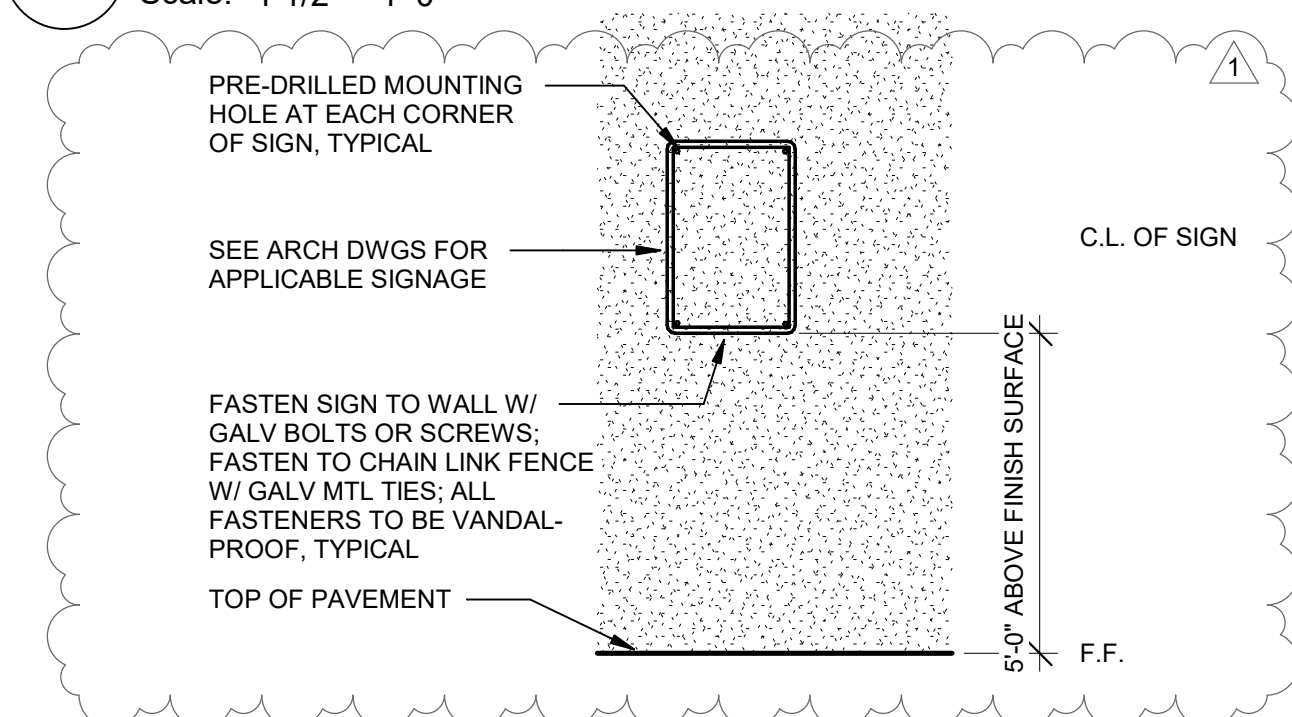

**10 WALL & FENCE MOUNTING SIGN**  
Scale: 1" = 1'-0"

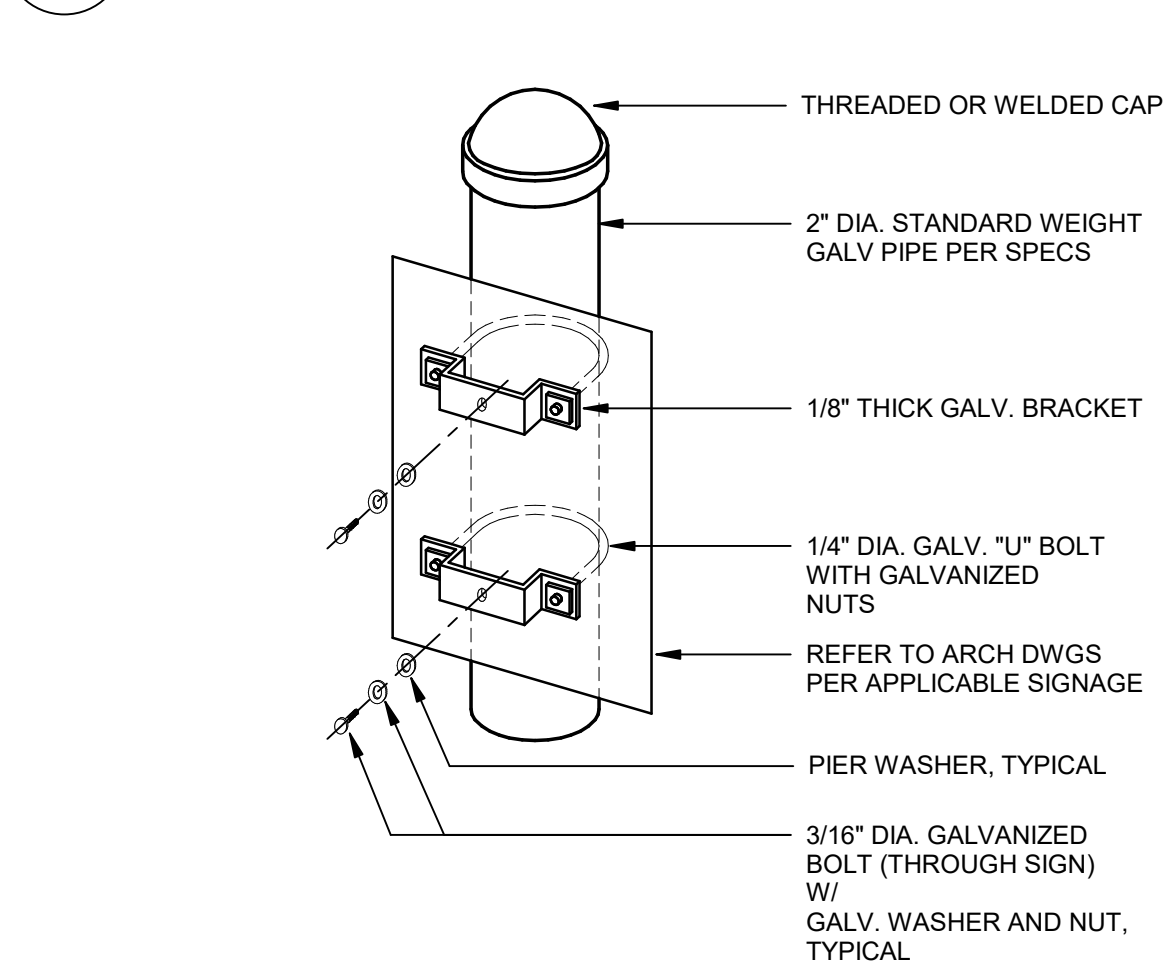

**9 SIGN ATTACHMENT DET**  
Scale: 1" = 1'-0"

**8 POST MOUNTED SIGN**  
Scale: 1" = 1'-0"

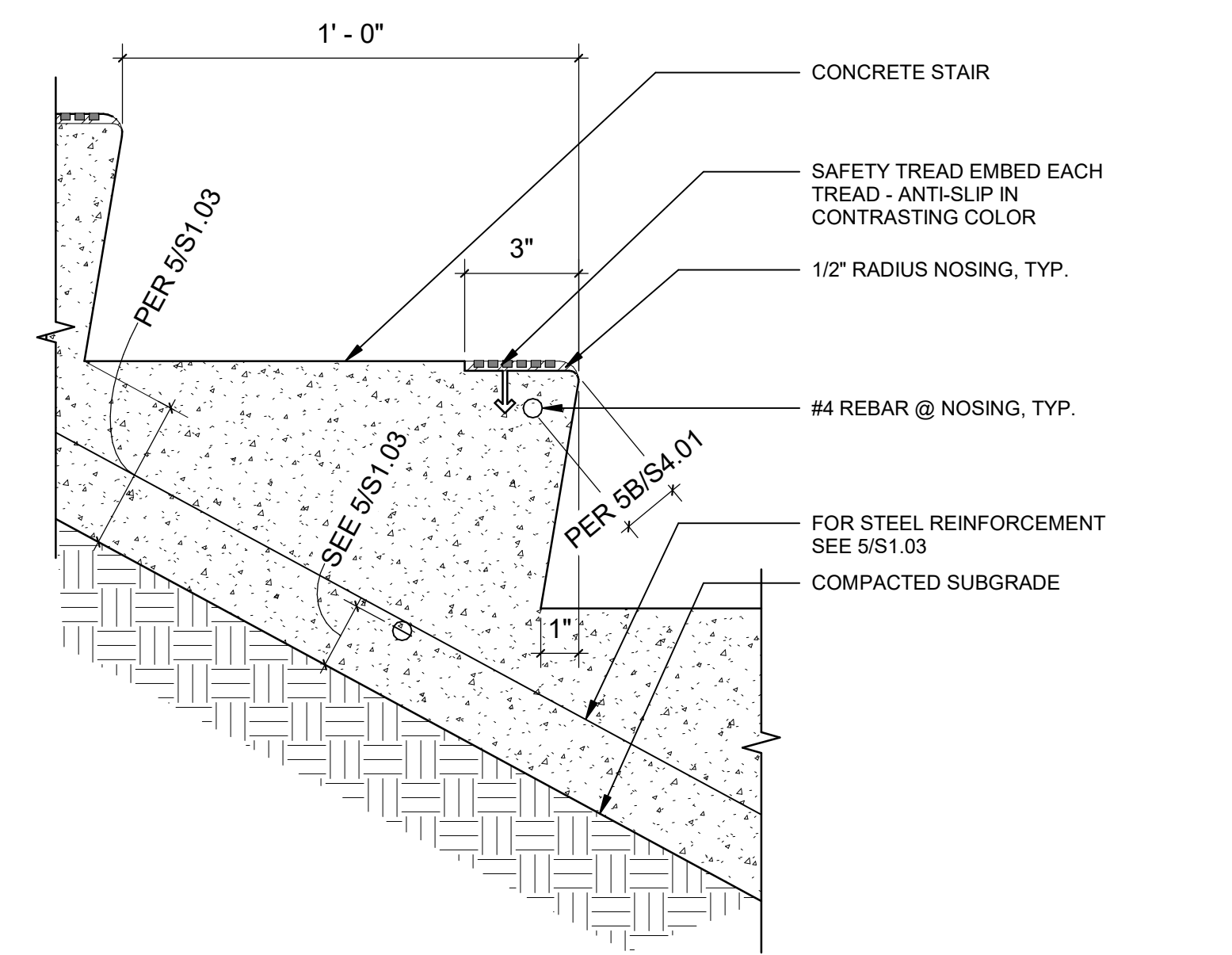

**7 STAIR NOSING**  
Scale: 3" = 1'-0"

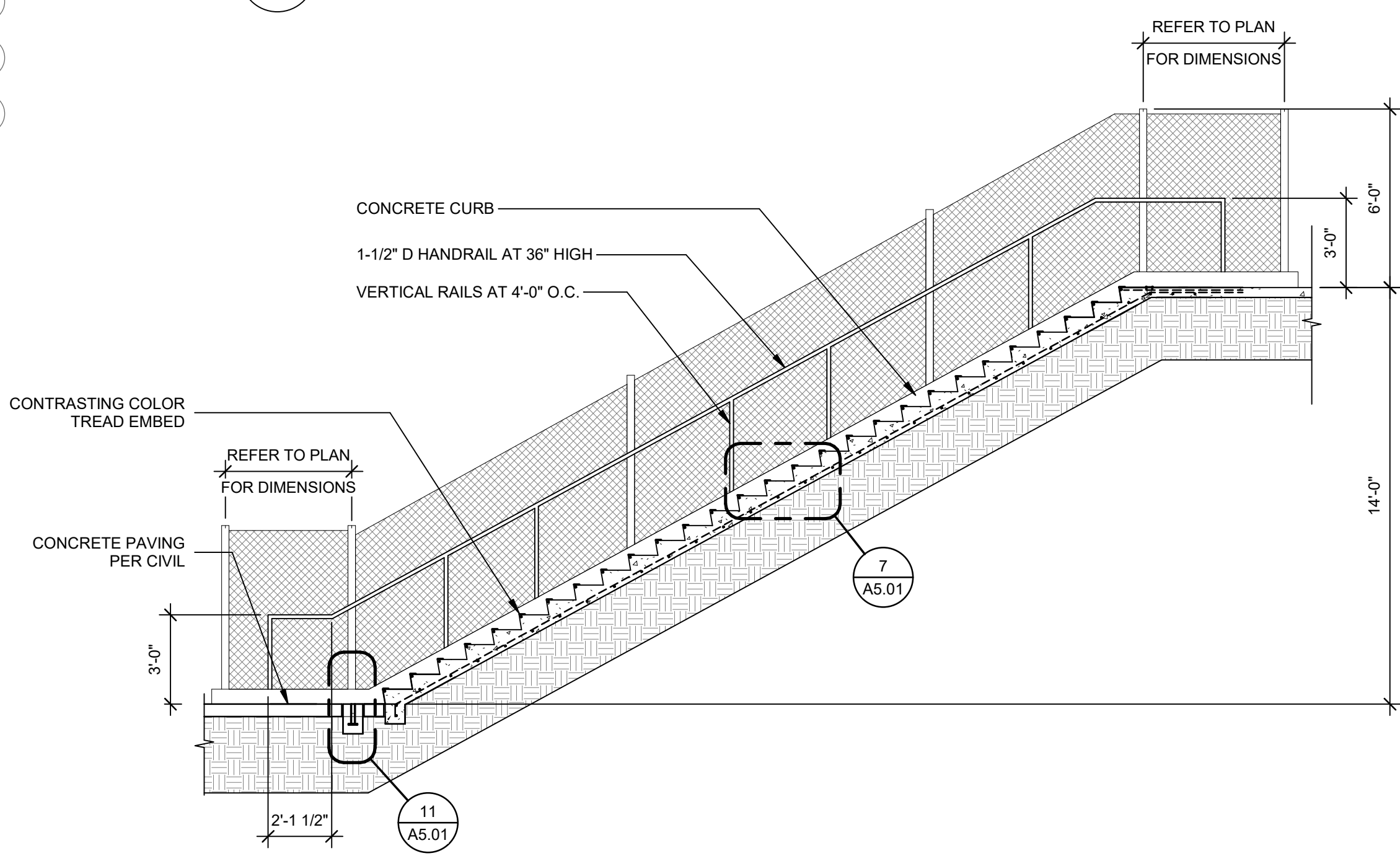

**6 STAIR SECTION**  
Scale: 1/4" = 1'-0"

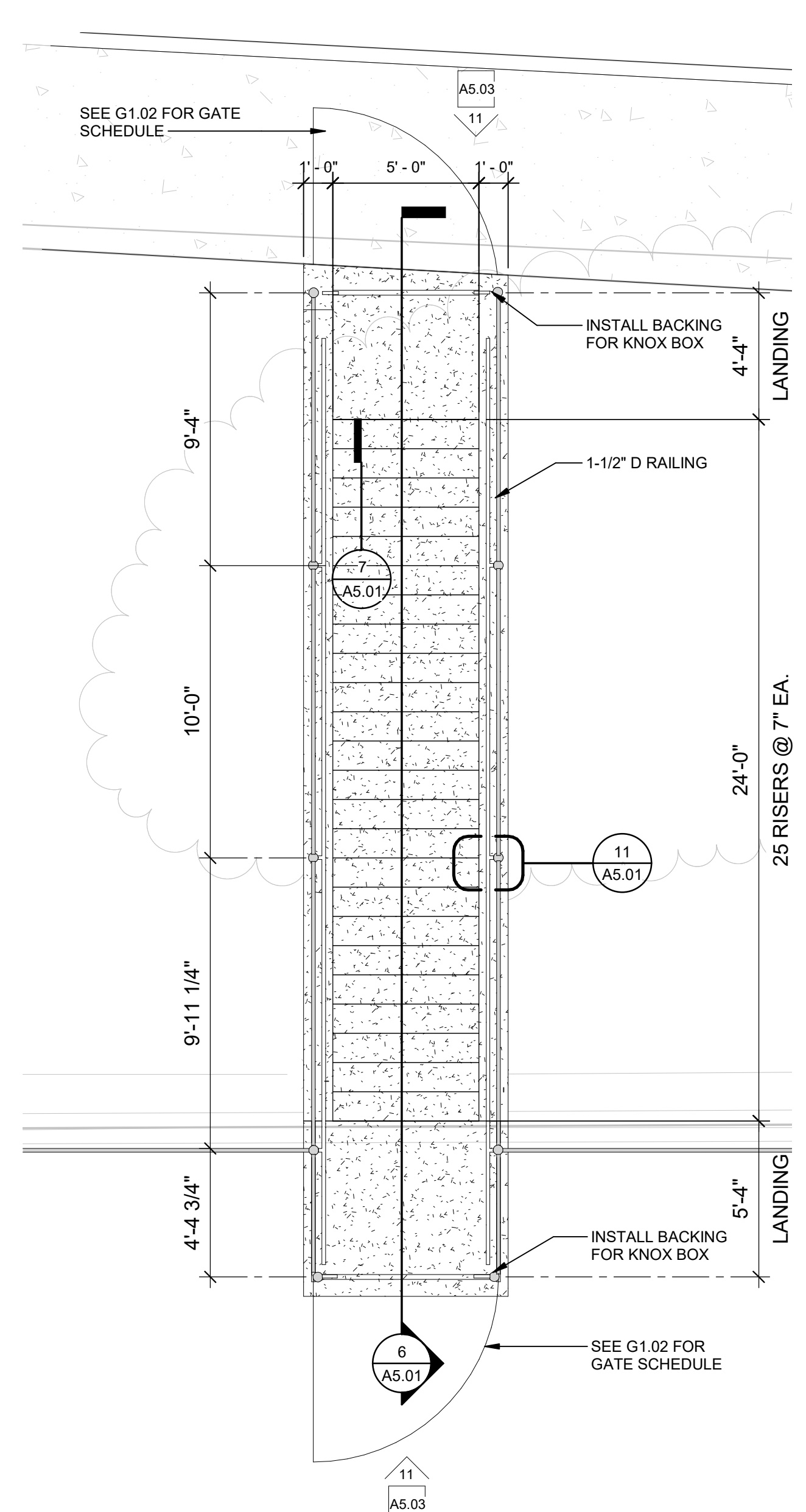

**5 ENLARGED STAIRS**  
Scale: 1/4" = 1'-0"

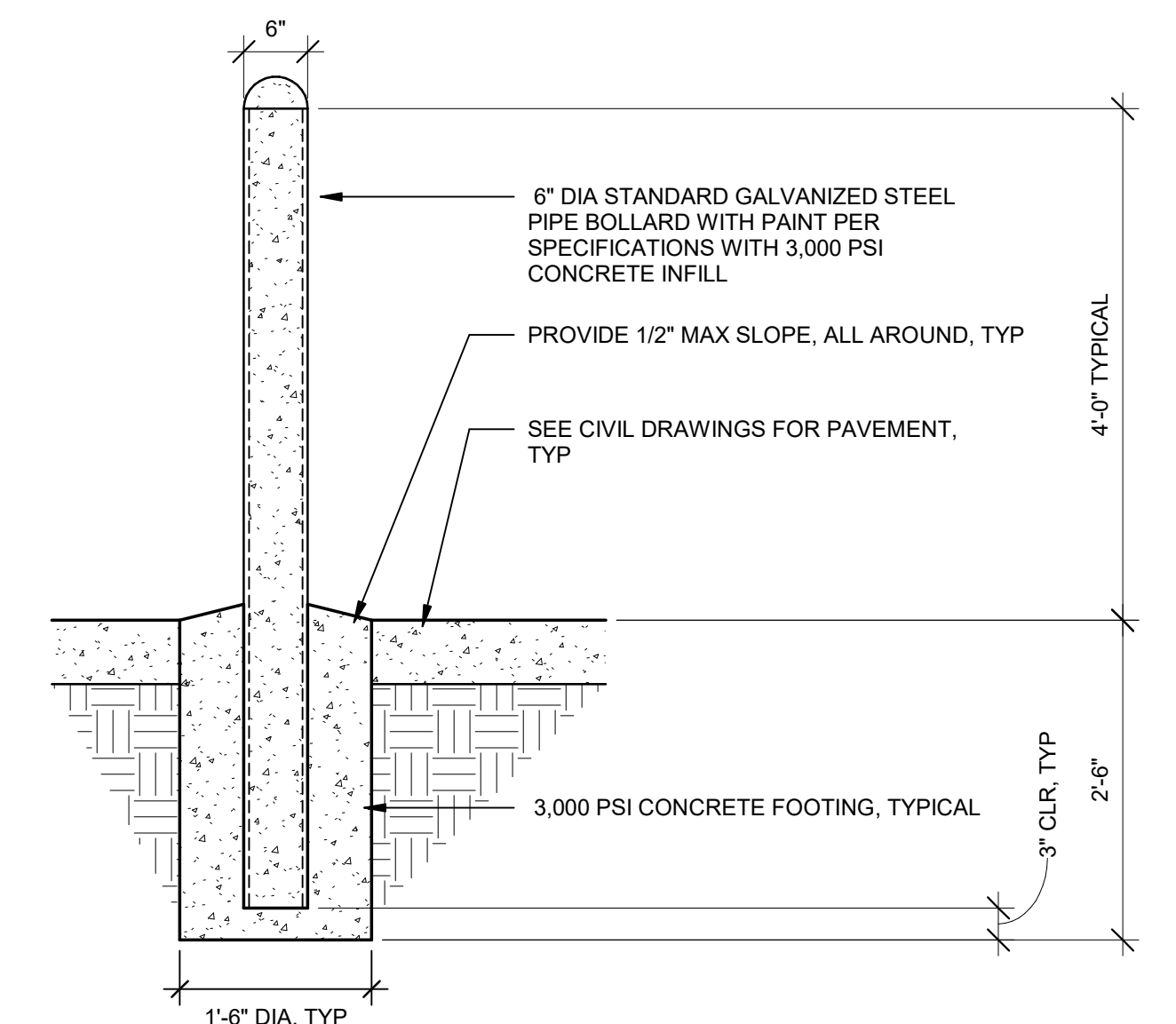

**4 BOLLARD**  
Scale: 3/4" = 1'-0"

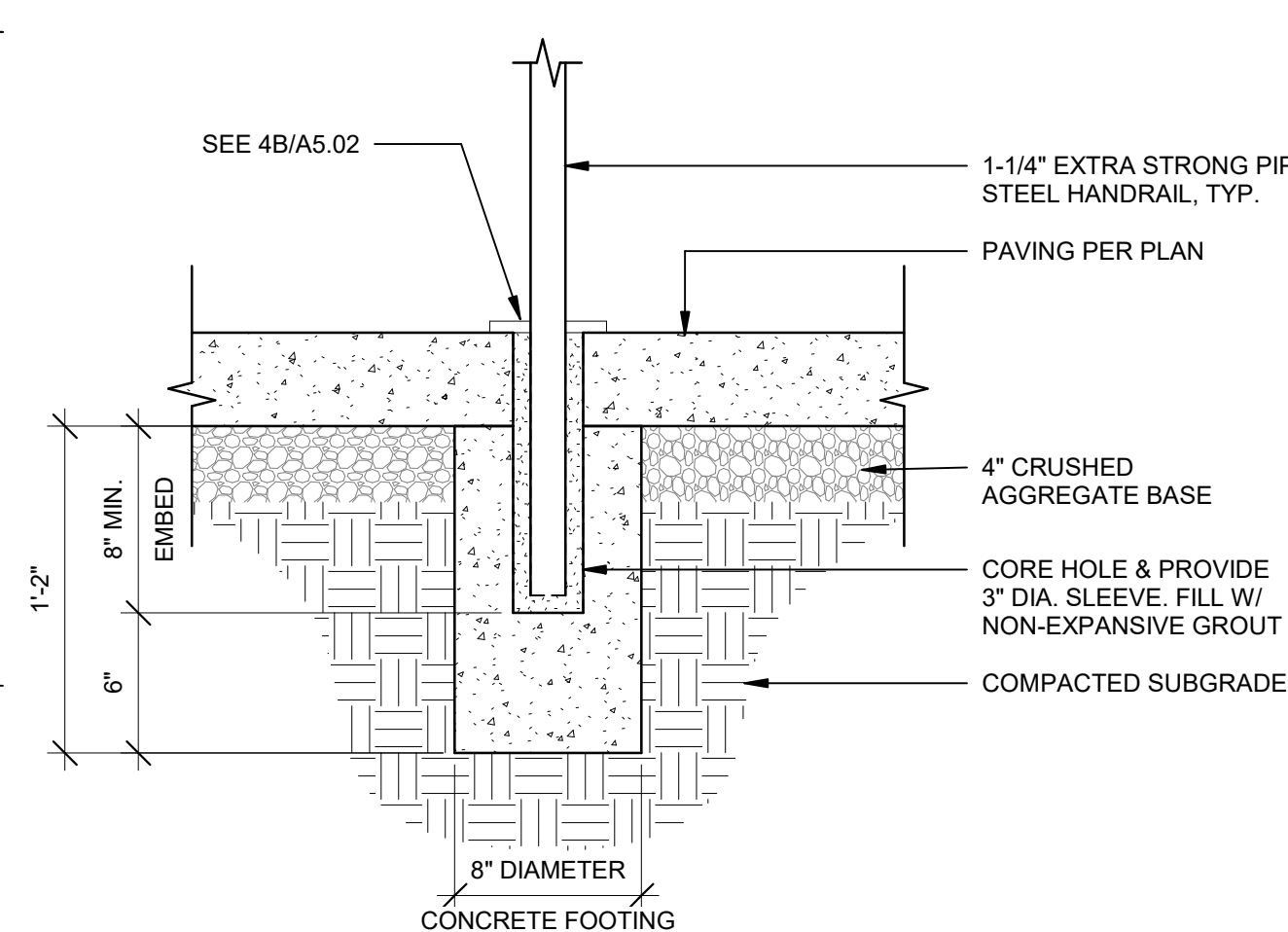

**3 POST EMBEDMENT, TYP.**  
Scale: 1 1/2" = 1'-0"

REVISIONS

1 ADDENDUM 1 02/01/2022

THIS APPROVAL IS FOR ITEMS WITHIN CLOUDED AREAS ONLY. FOR OTHER INFORMATION NOT CONTAINED WITHIN CLOUDED AREAS, REFER TO ORIGINAL DSA APPROVED PLANS.  
DO NOT USE THESE PLANS AS SUBSTITUTE FOR THE ORIGINAL DSA APPROVED PLANS.



NORWALK LA MIRADA UNIFIED SCHOOL DISTRICT  
**LA MIRADA HIGH SCHOOL NEW FOOTBALL STADIUM PROJECT**  
13520 ADELEA DRIVE, LA MIRADA, CA 90638

DSA # 03-120551

**NAC**  
ARCHITECTURE

NAC NO. 161-19015  
DATE 02/01/2022

ADDENDUM 1

EXTERIOR DETAILS

**A5.01**